



Perch, Stoop, Ledge Hang On Treestand

PN 82069, 82070, 82071

© 2012 Summit Treestands, LLC
715 Summit Dr. Decatur, AL 35601
(256) 353-0634
info@summitstands.com
www.summitstands.com



You **MUST** also view the enclosed DVD **BEFORE** using your new treestand!!

WEIGHT LIMIT (all models)

**SINGLE USER
300 LBS. X 1 TOTAL***

**DO NOT EXCEED THIS LIMIT!
(* Includes all gear)**

Stand minimum and maximum tree size: 8-20" diameter



You must fully read, understand and follow these warnings and instructions (written and video)! Failure to follow these instructions may cause serious injury or death!!

- **WHEN HUNTING FROM A TREESTAND FALLS CAUSING INJURY OR DEATH CAN OCCUR ANY TIME AFTER LEAVING THE GROUND!** FOR THOSE REASONS ALWAYS USE A FALL ARREST SYSTEM (FAS) COMPRISING A FULL BODY HARNESS AT ALL TIMES AFTER LEAVING THE GROUND. YOU MUST STAY CONNECTED AT ALL TIMES AFTER LEAVING THE GROUND WHILE USING ANY ELEVATED HUNTING PLATFORM. SINGLE SAFETY BELTS AND CHEST HARNESSES ARE NO LONGER ALLOWED AND SHOULD NEVER BE USED. IF YOU ARE NOT USING A FULL BODY HARNESS THAT IS PROTECTING YOU FROM A FALL, DO NOT LEAVE THE GROUND!
- READ AND UNDERSTAND ALL OF THE MANUFACTURER'S WARNINGS AND INSTRUCTIONS AND USE ALL SAFETY DEVICES PROVIDED. CONTACT SUMMIT TREESTANDS FOR ANY QUESTIONS. FAILURE TO DO SO COULD RESULT IN INJURY OR DEATH!
- A SIGNAL DEVICE SUCH A MOBILE PHONE, RADIO, WHISTLE, SIGNAL FLARE OR PERSONAL LOCATOR DEVICE (PLD) MUST BE ON YOUR PERSON AND READILY AVAILABLE AT ALL TIMES! ALWAYS INFORM SOMEONE OF YOUR HUNTING LOCATION, WHERE THE TREESTAND WILL BE LOCATED AND THE EXPECTED DURATION OF THE HUNT!
- DO NOT USE ANY TREESTAND UNLESS YOU ARE IN GOOD PHYSICAL SHAPE AND HAVE NO PHYSICAL LIMITATIONS OR MEDICAL CONDITIONS WHICH MAY PREVENT YOU FROM SAFELY USING THIS PRODUCT. ALWAYS CONSULT A PHYSICIAN IF YOU HAVE ANY QUESTIONS ABOUT YOUR PHYSICAL ABILITY TO USE THIS PRODUCT.
- NEVER USE A TREESTAND WHILE TAKING DRUGS, ALCOHOL OR CERTAIN PRESCRIPTION DRUGS! ALWAYS CONSULT A PHYSICIAN IF YOU HAVE ANY QUESTION ABOUT TAKING SPECIFIC MEDICATIONS AND USING THIS PRODUCT!
- NEVER USE A TREESTAND DURING INCLEMENT WEATHER SUCH AS RAIN, LIGHTNING, WINDSTORMS OR ICY CONDITIONS! END YOUR HUNT AND RETURN TO THE GROUND IF ANY OF THESE INCLEMENT CONDITIONS ARISE.
- NEVER USE A TREESTAND WHEN FEELING ILL, NAUSEOUS, DROWSY OR DIZZY!
- BE WELL RESTED AND NEVER HURRY. HURRYING CAUSES ACCIDENTS!
- NEVER USE A TREESTAND ON A DEAD, LEANING, DISEASED, LOOSE BARKED TREE, ON A UTILITY POLE OR ON TREES THAT HAVE ANY OBSTRUCTIONS THAT MAY LIMIT TREESTAND USE! NEVER RELY ON A TREE BRANCH FOR SUPPORT!
- NEVER JUMP OR BOUNCE ON A TREESTAND TO SECURE IT TO THE TREE!
- PULL UP A BOW, BACKPACK, FIREARM OR OTHER EQUIPMENT ONLY AFTER BEING SECURE IN THE TREESTAND. FIREARMS MUST BE PULLED UP UNLOADED, CHAMBER OPEN AND MUZZLE DOWN! NEVER CLIMB WITH ANYTHING ON YOUR BACK.
- NEVER MODIFY YOUR STAND IN ANY WAY BY MAKING REPAIRS, REPLACING PARTS, OR ALTERING, ADDING OR ATTACHING ANYTHING TO IT EXCEPT IF EXPLICITLY AUTHORIZED IN WRITING BY THE MANUFACTURER!
- PRACTICE INSTALLING, ADJUSTING AND USING YOUR TREESTAND AT GROUND LEVEL PRIOR TO USING IT AT ELEVATED POSITIONS!
- INSTRUCTIONS (WRITTEN AND VIDEO) SHOULD BE KEPT IN A SAFE PLACE AND REVIEWED AT LEAST ANNUALLY. IT IS THE RESPONSIBILITY OF THE TREESTAND OWNER TO FURNISH THE COMPLETE INSTRUCTIONS TO ANY PERSON WHO BORROWS OR PURCHASES THE TREESTAND! THIS SUMMIT TREESTAND IS DESIGNED TO BE USED AS A COMPLETE SYSTEM - NEVER LOAN OR SELL ONLY A PORTION OF THE HANG-ON TREESTAND SYSTEM.
- BEFORE EACH USE OF YOUR SUMMIT TREESTAND, ALWAYS INSPECT THE TREESTAND AND HARNESS FOR ANY DAMAGE, CRACKS, TEARS, CABLE WEAR OR ABRASION THAT MAY HAVE OCCURRED IN TRANSPORTING / STORING YOUR TREESTAND. DO NOT USE IF ANY DAMAGE IS FOUND! CONTACT CUSTOMER SERVICE FOR THE APPROPRIATE REPAIR / REPLACEMENT PROCEDURE!
- DO NOT LEAVE YOUR TREESTAND OUTDOORS OR STORE IT OUTDOORS WHEN IT IS NOT BEING USED! ANY STAND TUBING THAT IS ALLOWED TO FILL WITH RAINWATER AND FREEZE WILL RUPTURE OR BURST - DO NOT USE YOUR TREESTAND IF THIS OCCURS!

1 INDEX

GENERAL WARNINGS AND PRECAUTIONS, STAND WEIGHT LIMITS
 SECTION 1 - INDEX
 SECTION 2 - PARTS LIST
 SECTION 3 - TOOLS REQUIRED
 SECTION 4 - ASSEMBLY
 SECTION 5 - INSTALLATION AND USE
 SECTION 6 - TIPS
 SECTION 7 - MAINTENANCE AND CARE
 SECTION 8 - HARNESS SUSPENSION
 SECTION 9 - LIMITED WARRANTY

PG 1
 PG 2
 PG 2
 PG 2
 PG 3
 PG 3 - 6
 PG 7
 PG 8
 PG 8
 PG 8

2 PARTS LIST

Please call 256-353-0634 or visit <http://www.summitstands.com/contactus/> if you have any questions, if you need replacement parts, if you have any missing parts or if the included DVD does not play.

BOX CONTENTS

PN	DESCRIPTION	QTY
INCLUDES ONE OF THE FOLLOWING:		
82069.100	PERCH PLATFORM	1
82070.100	STOOP PLATFORM	1
82071.100	LEDGE PLATFORM	1
	SEAT UPRIGHT BAR	1
	SEAT PAN	1
	HANGING TAB	2
	STANDOFF TAB	2
	CABLE	2
	FOAM SEAT	1

ACCESSORY PACKET CONTENTS

DESCRIPTION	QTY
HARDWARE BAG	1
LINEMAN'S BELT	1
HANGING STRAP WITH J HOOKS	1
GREEN TOURNIQUET STRAP W/ BUCKLE	1
SUMMIT 4 POINTS SAFETY HARNESS W/ ATTACHED SRS STRAP	1
HARNESS SAFETY STRAP	1
WRITTEN HARNESS INSTRUCTIONS	1
SAFETY AND INSTRUCTIONAL DVD	1
WARRANTY CARD	1

HARDWARE PACKET

All bolts used are 1/4" threads, grade 5.

DESCRIPTION	QTY
1 1/2" BOLT, 1/4x20	2
2" BOLT, 1/4x20	4
2 3/4" BOLT, 1/4x20	2
LOCK NUT, 1/4x20	8
1/4" WASHER	4

3 TOOLS REQUIRED

Tools

- 7/16" Wrenches and / or Socket / Ratchet

- Assembly can be made easier by the use of a powered ratchet or drill with socket adapter (take care not to overtighten when using power tools to assemble)

Use

Main Bolts / Nuts - 1/4x20 hardware

4 ASSEMBLY

SEAT UPRIGHT

1. Position two Standoff Tabs on the inside of the Seat Upright Bar as shown in **figure 1**. Use two of the **1/4" Washers** on the outside of the Seat Upright tubing.
2. Slide the Seat Pan up and line up the holes. The expanded metal side of the Seat Pan should face up as shown in **figure 2**. Use two, **2 3/4" bolts and lock nuts** to secure the Seat Pan, Washers, Upright and Standoff Tabs as shown.
3. Position the platform below the completed Seat Upright Assembly. The expanded metal side of the Platform should face up. Use two **1/4" washers** between the Upright Bar and the two welded tabs on the platform as shown in **figure 3**.
4. Slide the Seat Upright down between the tabs and secure using two **2" bolts and lock nuts** (as shown in **figure 4**.)

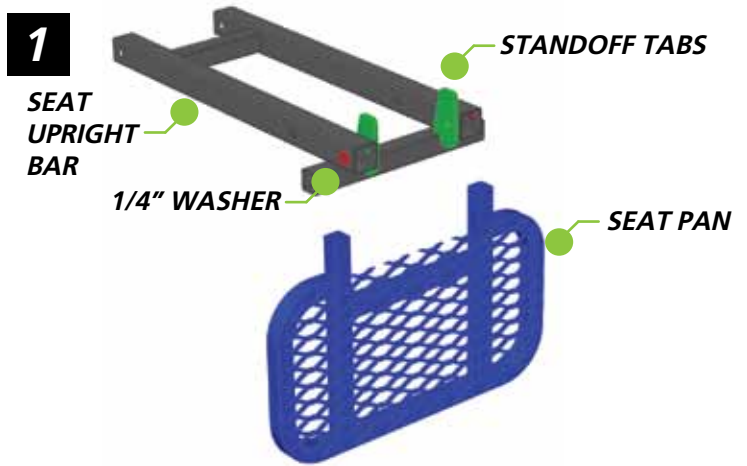

2 3/4" BOLTS, LOCK NUTS - WRENCH TIGHTEN

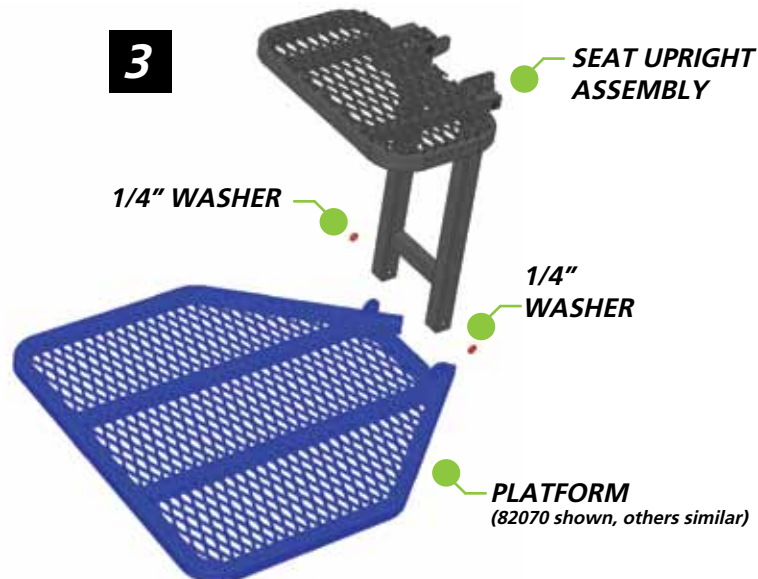
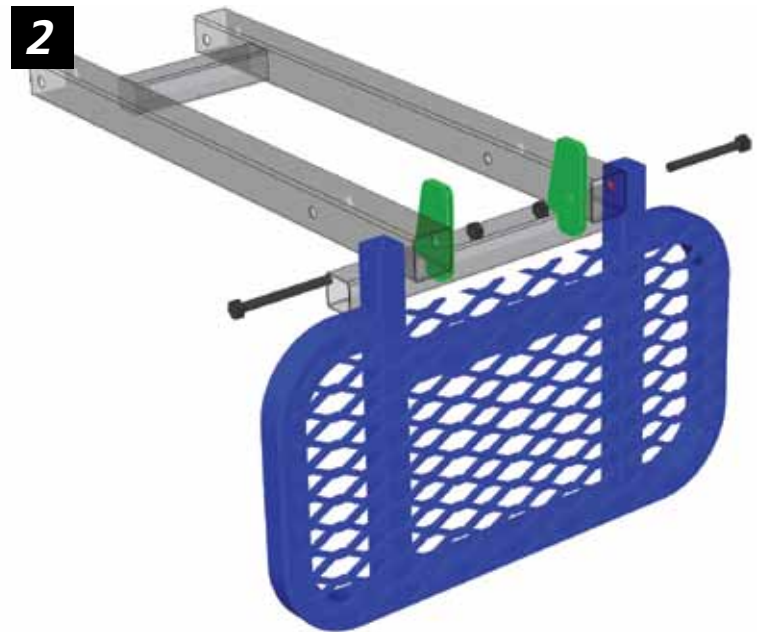

2" BOLTS, LOCK NUTS - WRENCH TIGHTEN

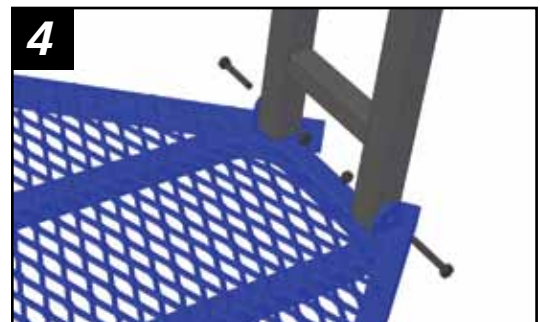

CABLES

1. Position one of the Hanging Tabs as shown in **figure 5**. The bent end of the tab should wrap around the Upright tube and the open end should face the tree.
2. Line up one end of the cable with the same hole. The flat portion of the cable eyelet should sit flush against the Hanging Tab as shown in **figure 6**. Secure using one **2" bolt and lock nut**.
3. Attach the lower end of the cable to the Platform as shown in **figure 7** using one **1 1/2" bolt and lock nut**. The flat portion of the cable eyelet should sit flush against the platform tubing as shown in **figure 8**.
4. Repeat **Steps 1 - 3** for the other Cable / Hanging Tab.

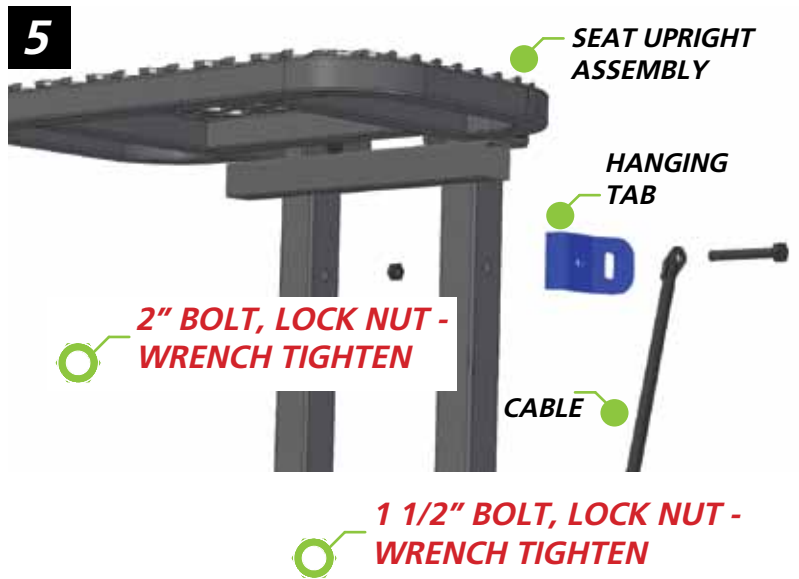

SEAT

1. Slide the sewn pouch on the Seat over the Seat Pan as shown in **figure 9**.
2. Secure the seat using the hook and loop strips shown in **figure 10**.

NOTICE

The foam seat included with these treestands is removable for storage. **DO NOT** leave your stand outdoors when it is not being used.

5 INSTALLATION AND USE

⚠ WARNING

The use of a lineman's style climbing belt / rope is mandatory when installing or climbing into a hang-on treestand. **NEVER** attempt to install or climb into a hang-on treestand without being stabilized by a lineman's style climbing belt.

INSTALLATION

1. Connect a pull-up rope (not included) to your hang-on platform. The supplied green tourniquet strap with the spring loaded buckle should be securing the seat frame to the platform. Connect one end of the pull-up to your person.

⚠ WARNING

ALWAYS use a pull up rope to raise and lower the stand. **NEVER** climb with anything on your back.

2. **USING THE SUPPLIED HARNESS AND LINEMAN'S CLIMBING BELT**, Slowly and carefully climb to your desired hunting height.

⚠ WARNING

Climbing aids (Stick Ladders, Sectional Ladders, Steps, etc...) **MUST EXTEND ABOVE** the final position of the hang-on platform. **ALWAYS** step down from the climbing aid onto your platform. **NEVER** attempt to climb up onto a hang-on platform from a climbing aid mounted below the platform.

3. Haul your hang-on treestand up to your current position using your pull-up rope.

4. While supporting the stand, hook the double J-hook of the Hanging Strap through the Hanging Tab as shown in **figure 9**. **The double J-hook must be attached as shown in figure 10 (flat side toward the tree)**.

5. Bring the other end of the Hanging Strap around the tree and hook the double J-hook into the opposite Hanging Tab. **Again, note that the J-hook must attach flat side toward the tree as shown in figure 10**. Make sure there are not any twists in the strap.

6. Repeatedly pull the free webbing end of the strap to cinch it down to the tree.

⚠ WARNING

ALWAYS follow all warnings and expiration dates listed on the Hanging Strap warning label. **ALWAYS** inspect the strap for wear and cuts before each use. **NEVER** use a damaged strap.

7. Use the green tourniquet buckle strap to secure the lower part of the platform to the tree. Run the strap around the Seat Support Tubes as shown in **figure 11**, around the tree and through the buckle. Pull to secure.

⚠ WARNING

Correct tightening and adjustment of the Hanging Strap is critical to stable hang-on stand installation. All treestand contact points **MUST BE IN CONTACT** with the tree before you step onto your stand!

⚠ WARNING

YOU MUST read and understand the included **Full Body Harness Instructions, Page 5, Section 5** for information on using your Lineman's Belt. **YOU MUST** be wearing the supplied 4 point, full body harness and lineman's climbing belt before attempting to install or climb into this treestand.

⚠ WARNING

NEVER rely on a tree branch for support while climbing into or out of a hang-on treestand.

⚠ WARNING

NEVER use screw in steps as they can damage the tree and can be hazardous if you slip.



INSTALLATION (continued)

8. While staying connected to your lineman's belt, position the safety harness safety strap above the stand. **Following the written Harness Instructions**, take your treestand safety strap and run it through the harness tether loop. Thread the safety strap buckle and pull tight as shown in **figure 12**.

9. Once you and your harness are securely connected to the harness safety strap, **THEN AND ONLY THEN** should you disconnect from your lineman's belt. **CAREFULLY STEP DOWN** onto the platform.

⚠ WARNING

ALWAYS position your safety harness above your head so that the tether length is minimized at all times.

⚠ WARNING

NEVER jump or bounce on the platform in an attempt to cause it to dig into the tree.

USE

⚠ CAUTION

NEVER leave a hang-on treestand in a tree for more than two weeks at a time. Weather, animals and tree growth can damage the stand, attachment straps and buckles.

REMOVAL

⚠ WARNING

The use of a lineman's style climbing belt / rope is mandatory when removing or climbing out of a hang-on treestand. **NEVER** attempt to remove or climb out of a hang-on treestand without being stabilized by a lineman's style climbing belt.

1. **Following the written Full Body Harness Instructions**, and while you are still connected to your harness safety strap, connect to the tree using your lineman's belt hookup.
2. Carefully climb onto your climbing aid.
3. Unhook your tether from the harness safety strap.
4. Disconnect the green tourniquet strap securing the platform to the tree.
5. Fold the platform up and secure the platform to the seat frame by wrapping the green strap around the platform / seat frame.
6. Attach your pull-up rope to the stand.
7. Pull on the short green strap attached to the Hanging Strap (**figure 13**) to release the tension on the buckle.
8. Unhook the double J-hook from the Hanging Tab.
9. Lower the stand to the ground.
10. Carefully descend your Climbing aid using your lineman's belt until you are on the ground.



6 TIPS Sometimes on a cold, dry, hard bark tree a rubbing noise can be produced at the scalloped edge that engages the tree. This comes from friction forces. It can be eliminated a couple of ways. First, simply re-positioning your platform slightly will in most cases eliminate the noise. Second, a liquid or candle/ bowstring wax can be applied at the intersection of the tree and the scalloped edge to reduce the friction. Also, using a file to remove the finish and slightly upset (roughen) the smooth metal surface contact points on the scallops can eliminate the noise.

Changing your sitting position can relieve muscle stress and reduce fatigue. This will allow a longer hunt and perhaps an opportunity for a shot. Being comfortable will result in no movement and reduce being detected by game either from sight or from sound.

Summit recommends the use of the Swifttree (PN 82050 and PN 82051) and Bucksteps (PN 82008) Climbing Aids both sold separately.

SWIFTTREE
(PN 82050, 82051)



BUCKSTEPS
(PN 82008)



Summit recommends the use of the Seat-O-The-Pants Climbing system (PN 83014 or 83024) for any Hang-On stand. After hooking the SOP Climbing System to the tree you can climb and stay connected directly to your safety harness at all times.

SOP CLIMBING SYSTEM
(PN 83014)



**SOP CLIMBING SYSTEM
COMBO PACK (3 ROPES)**
(PN 83024)



7 MAINTENANCE AND CARE

The seat on this treestand is removable. We recommend it be removed and stored in a dry place when not in use.

The powdercoat finish applied at the factory is very durable and should only need touch ups in areas of heavy wear or accidental impact.

Should you damage any part of your Summit Treestand, contact your nearest authorized Summit dealer or the factory to obtain the proper corrective action procedure and/or replacement parts for the treestand.

⚠ CAUTION

Look for nicks, gouges, cuts, cracks, bends, corrosion or similar damage that can be the result of improper use or accidental damage. For instance, this could occur if someone else used the treestand without knowledge of its proper use, or if the treestand were dropped, hit by a motor vehicle or subject to corrosive conditions, etc.

Summit Treestands have the highest structural integrity by design, material selection and manufacturing techniques, but as its owner, only your continued care will assure trouble free performance. When the above-mentioned guidelines are followed, your Summit Treestand will provide years of successful hunting.

8 HARNESS SUSPENSION

It is necessary and very important that someone knows your hunting location and time of return. It is also very important that you carry (on your person) emergency communication devices such as a cell phone, two-way radio, whistle, signal flare or preferably a PLD (Personal Locator Device - FCC approved July, '03). When triggered, a PLD will transmit an emergency signal to local rescue teams identifying your location via satellite GPS coordinates. PLD's may be purchased at Wilderness outfitters or on the internet.

Suspension trauma or blood pooling can occur when suspended motionless in a harness for periods of time. This can lead to unconsciousness and death. A suspension relief strap is furnished with your harness. Read your harness instructions to assure that you know how to use it.

⚠ WARNING

If you have to hang in the tree before help arrives, you need to exercise your legs by pushing off from the tree or by using the enclosed suspension relief strap. See the treestand harness instructions and the enclosed instructions for more information.

Self extraction may be necessary in the unfortunate situation that (A) no one knows your location, (B) your communication efforts are exhausted, (C) you are confident that you have the strength, dexterity and ability to perform self-extraction and (D) you decide this is your "absolute last resort". It is recommended to carry a device to assist with this self-extraction. Simple devices such as screw-in steps or a rope "Tree Descender" (available from Summit) will allow you to remove the weight from your harness. This may enable you to return to the treestand/ladder/climbing steps or slowly descend the tree.

Several optional products/systems are available that offer self-recovery or self extraction from a fall when suspended in a harness. Returning to the ground obviously also relieves suspension trauma and some systems automatically descend the user while others allow user control. If one of these products/systems is selected for use as an additional safety precaution against prolonged suspension, be sure to follow the manufacturers' directions for safe use.

9 LIMITED WARRANTY

(A) Warranty

Summit Treestands, LLC (Summit) warrants to the original retail purchaser that all products manufactured by it are free from defects in material and manufacture at the time of shipment for twelve (12) months from the date of purchase. Summit will repair or replace any part found defective if the unit claimed to be defective shall be returned to Summit, postage prepaid, within the warranty period.

This warranty shall not apply to any product which has been subjected to misuse; misapplication; neglect (including but not limited to improper maintenance); accident; improper installation; modification (including but not limited to use of unauthorized parts or attachments); adjustment or repair. THE FOREGOING IS IN LIEU OF ALL OTHER WARRANTIES, WHETHER EXPRESS OR IMPLIED (INCLUDING THOSE OF MERCHANTABILITY AND FITNESS OF ANY PRODUCT FOR A PARTICULAR PURPOSE), AND OF ANY OTHER OBLIGATION OF LIABILITY ON THE PART OF THE COMPANY.

(B) Limitation of Liability

It is expressly understood that Summit's liability for its products, whether due to breach of warranty, negligence, strict liability, or otherwise, is limited to the repair of the product, as stated above, and Summit will not be liable for any other injury, loss, damage, or expense, whether direct or consequential, including but not limited to loss of use, income, profit, or damage to material, arising in connection with the sale, installation, use of, inability to use, or the repair or replacement of Summit's products.

Summit reserves the right to make alterations or modifications in its products at any time, which in its opinion, may improve the performance and efficiency of the product. It shall not be obligated to make such alterations or modifications to products already in service.

Please take the time to fill out the warranty card online at <http://www.summitstands.com/warranty> or fill out and mail in the enclosed warranty card.

© 2012 Summit Treestands, LLC
715 Summit Dr. Decatur, AL 35601
(256) 353-0634
info@summitstands.com