

# INSTRUCTIONS

## ⚠ WARNING

Never sit on this gun rest or attempt to use it as a climbing aid!

## 1 PARTS LIST

### BOX CONTENTS

PN	DESCRIPTION	QTY
	GUN REST TUBE	1
70224	18" CAMO ARM PAD	1
10656	IN-LINE CABLE TIES	6
21071	GUN REST HARDWARE KIT	1

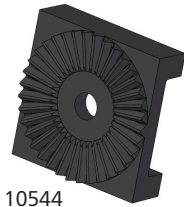

### 21071 - GUN REST HARDWARE PACKET

PN	DESCRIPTION	QTY
10632	2 1/2" CARRIAGE BOLT, 1/4x20	2
10601	1 3/4" BOLT, 1/4x20	2
10612	LOCK NUT, 1/4x20	2
10633	NEOPRENE WASHER	2
10544	GUN REST ADJUSTMENT BRACKET	4
10660	KNOB	2
20431	GUN REST MOUNTING BRACKET	2

## 2 ASSEMBLY

- Position the Gun Rest Mounting Bracket as shown in **figure 1**. The bracket **MUST** be placed at least 3" up the arm to provide clearance for the platform when the stand is packed together. The long side of the bracket should be on the outside of the stand.
- Secure the bracket using one 1 3/4" bolt and lock nut. The bolt **MUST** run from the outside in as shown in **figure 2 (bolt is in yellow)**. Repeat for the other side.
- From the inside, position the 2 1/2" carriage bolt (shown in blue) inside the bracket. Over this bolt, slide one Gun Rest Adjustment Bracket, one Neoprene Washer (red), one more Gun Rest Adjustment Bracket and then the Gun Rest Bar (bright green). See **figure 2**.
- Secure the bar with the supplied knob.
- At the other bracket location, combine one Adjustment Bracket, a Neoprene washer and the last Adjustment Bracket. Slide this assembly between the Gun Rest tube and the Mounting Bracket lining up the bolt hole. Insert the carriage bolt through the entire assembly from the inside out. Secure with the knob.
- Position the 18" Arm pad on the gun rest bar as shown in **figure 3**. Secure with two In-Line Cable Ties.

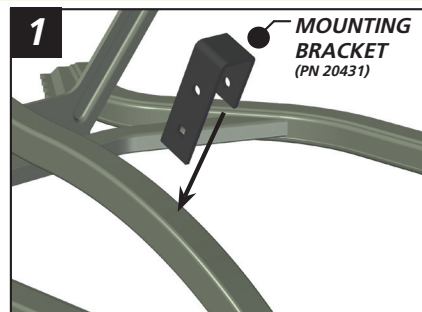

1 3/4" BOLT, LOCK NUT - WRENCH TIGHTEN

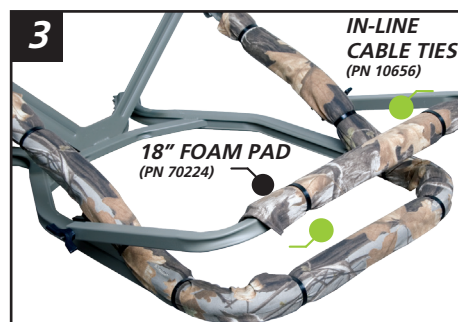
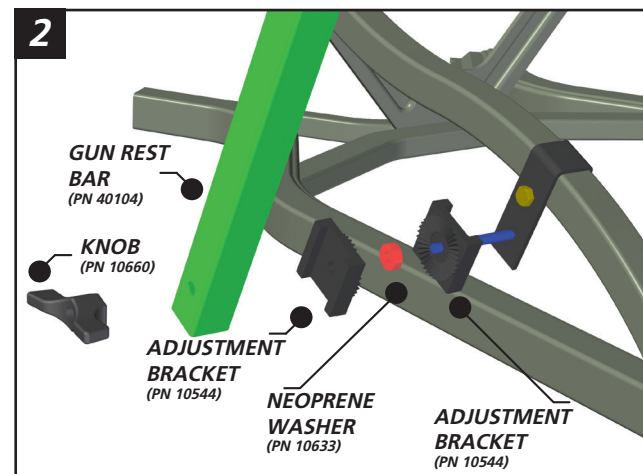

Adjustable Gun Rest



**SUMMIT**  
EST. 1981  
TREESTANDS