



SUMMIT
EST. 1981
TREESTANDS

Raptor Series Gun Rest

INSTRUCTIONS

! WARNING

You must fully read, understand and follow these warnings and instructions (written and video)! Failure to follow these instructions may cause serious injury or death!!

NEVER SIT ON THIS GUN REST OR ATTEMPT TO USE IT AS A CLIMBING AID!!!!

1 INDEX

GENERAL WARNINGS AND PRECAUTIONS
SECTION 1 - INDEX
SECTION 2 - PARTS LIST
SECTION 3 - INSTALLATION

PG 1
PG 1
PG 1
PG 2

2 PARTS LIST

BOX CONTENTS

PN	DESCRIPTION	QTY
60112	GUN REST BAR	1
60128	GUN REST MOUNTING BAR	1
60401	REAR MOUNTING BRACKET	1
	FRONT MOUNTING BRACKET	1
21056	GUN REST HARDWARE PACKET	1
70224	18" ARM PAD	1
10656	IN LINE CABLE TIE	2

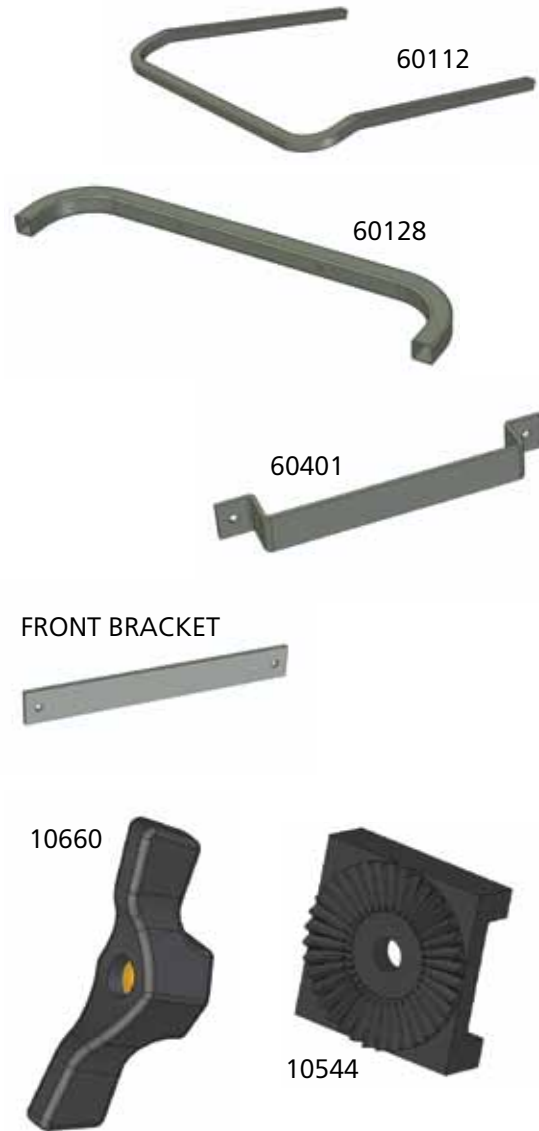

21071 - GUN REST HARDWARE PACKET

PN	DESCRIPTION	QTY
10632	2 1/2" CARRIAGE BOLT, 1/4x20	2
10601	1 3/4" BOLT, 1/4x20	2
10612	LOCK NUT, 1/4x20	2
10633	NEOPRENE WASHER	2
10641	SHORT SHANK BUSHING	2
10544	GUN REST ADJUSTMENT BRACKET	4
10660	KNOB	2
20431	GUN REST MOUNTING BRACKET	2

FORM# 18066 7/2010

3 INSTALLATION

⚠ WARNING

Never sit on this gun rest or attempt to use it as a climbing aid!

1. Position the Gun Rest Mounting Bar, the Front Mounting Bracket and the Rear Mounting Bracket as shown in **figure 1**.
2. Secure the Mounting Bar to the stand using two 1 3/4" bolts and lock nuts as shown in **figure 2**.
3. From the inside, position the 2 1/2" Carriage Bolt inside the Mounting Bar. Over this bolt, slide one Gun Rest Adjustment Bracket, one Neoprene Washer (red), one more Gun Rest Adjustment Bracket, the Gun Rest Bar (bright green) and one Short Shank Bushing (blue). See **figure 3**.
4. Secure the bar with the supplied knob.
5. At the other bracket location, combine one Adjustment Bracket, a Neoprene washer and the last Adjustment Bracket. Slide this assembly between the Gun Rest tube and the Mounting Bracket lining up the bolt hole. Insert the carriage bolt through the entire assembly from the inside out. Secure with the knob. The completed assembly should look like **figure 4**.
6. Position the 18" Arm pad on the gun rest bar as shown in **figure 5**. Secure with two In-Line Cable Ties.

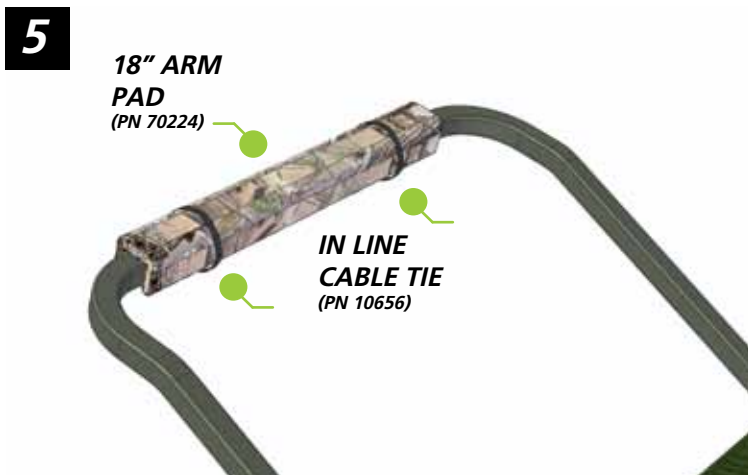
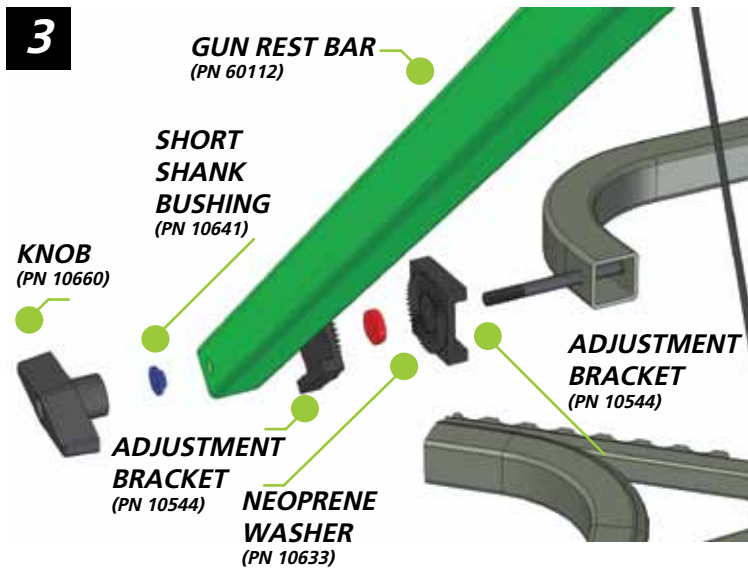
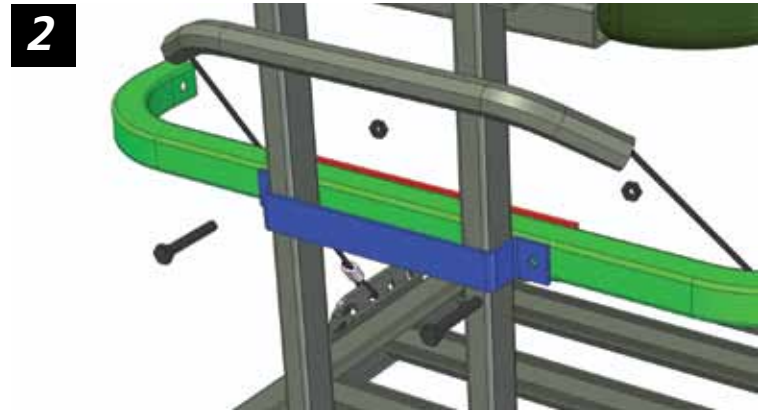
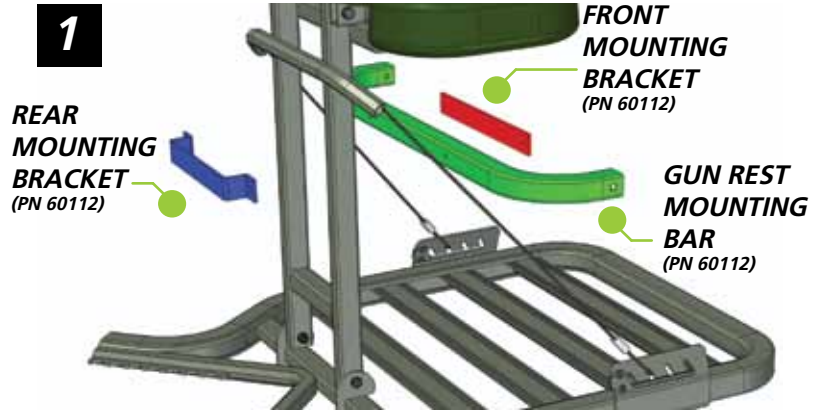

www.summitstands.com
www.mysummitgear.com