

Instruction Sheet MTCLL/LTLL



Customer service dept.
2245 Delany Rd
Waukegan, IL 60087

Ph: 847/224-1800 • 800/323-4656
Fax: 847/224-1818 • 800/327-1698



MTCLL/LTLL

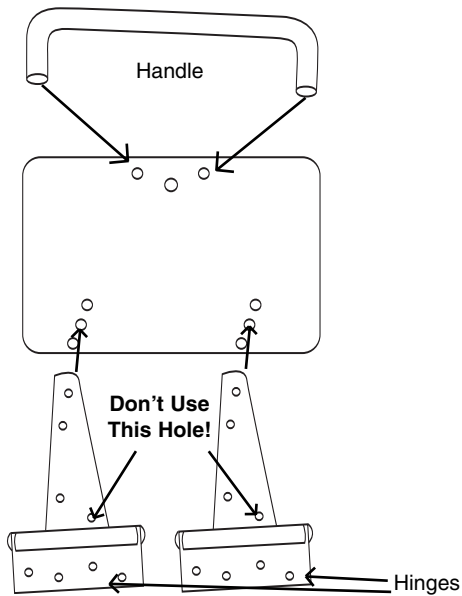

Step 1

Align handle holes to the two predrilled holes on the lid and attach with two screws.

Lid/Lock Assembly

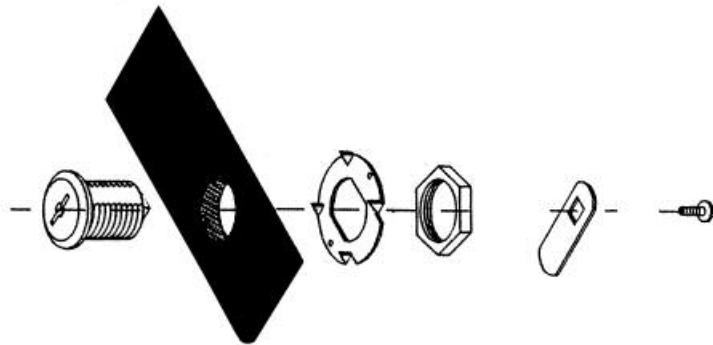

Attach the hinges as shown with six bolts and nuts. The last hole on the hinges won't be used.

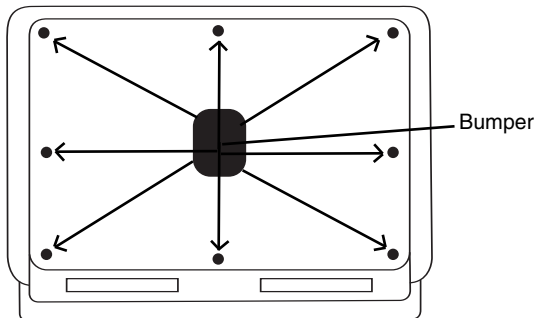

Step 2

Place plastic bumpers as shown in the diagram.

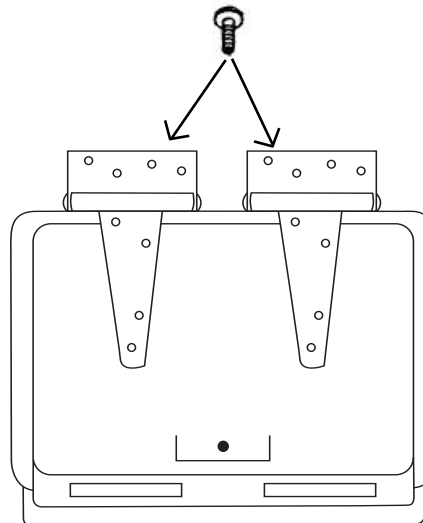

Step 3

Place lid on the top shelf and flip the back part of the hinge down to the back side of the top shelf and insert eight sheet metal screws into the plastic.

PARTS LIST

- 2 - Hinges **0089136**
- 1 - Lid **NB91247**
- 8 - Bumpers **0091121**
- 1 - Hardware pack
- 1 - Lock Assembly **0085132**