

# FOOTREST INSTRUCTIONS

## NOTICE

These instructions are only for installing the included footrest on the RS Hawk Deluxe (PN 81509). ALWAYS refer to the 2009 Raptor Series Hang-On Written Instructions for warnings and useage instructions.

## 1 PARTS LIST

Please call 256-353-0634 or visit <http://www.summitstands.com/contactus/> if you have any questions, if you need replacement parts, or if you have any missing parts.

### BOX CONTENTS

*In addition to the items listed on Page 2 of the 2009 Raptor Series Instructions, your treestand should include the following:*

PN	DESCRIPTION	QTY
40123	FOOTREST BAR	1
22029	FOOTREST HARDWARE PACKET	1
10903	CABELA'S EZ ARM BOWHANGER	1
	CABELA'S MONSTER BUCKS XIV DVD	1

### 22029 - FOOTREST HARDWARE KIT

PN	DESCRIPTION	QTY
10601	1 3/4" BOLT, 1/4x20	2
		
10612	LOCK NUT, 1/4x20	2
		
10640	LONG SHANK BUSHING	4
		
10641	SHORT SHANK BUSHING	2
		
10635	SELF TAPPING SCREW	4
		
10668	FOOTREST BUMPER	2
		
10122	FOOTREST MOUNTING BRACKET	2

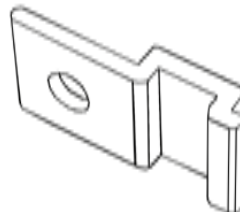

**SUMMIT**  
EST. 1981  
**TREESTANDS**



## 2 TOOLS REQUIRED

### Tools

- 7/16" Wrenches and / or Socket / Ratchet
- Powered Screwdriver

### Use

Footrest Attachment Bolts / Nuts  
Footrest self tapping screws

### FOOTREST

(Installation is made easier by the use of a powered screwdriver)

1. Insert the Footrest Bracket into the perimeter tube as shown in **figure 1**. This bracket should be placed between the first and second rung from the front of the platform.
2. Secure the bracket with one self tapping screw as shown in **figure 2**. Repeat for the other side.
3. Insert two of the long shank bushings into the pre-punched holes in each end of the footrest tube as shown in **figure 3**.
4. Insert the short shank bushing into the outside of each footrest bracket from **Step 1** (See **figure 4**).
5. Line up the footrest bar on the **INSIDE** of the two footrest brackets and secure one side using the 1 1/2" bolt and lock nut (**see figure 5**).
6. Insert the remaining 1 1/2" bolt through the other side of the footrest bar and pull the bar to the side so that you can tighten the lock nut. If squeaking occurs, loosen the bolts by 1/2 turn.
7. Fold the bar down and note where it crosses the stand frame - make a mark on the footrest at this point. Fold the bar back up. Secure the two rubber bumpers at the mark using the two remaining self tapping screws as shown in **figure 6**. Your finished footrest should look like **figure 7**.

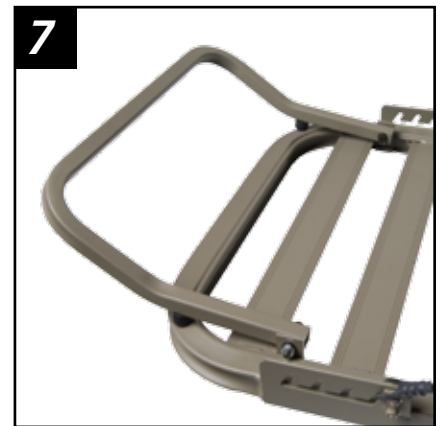

**FOOTREST BUMPER**  
(PN 10668)

Summit products are manufactured under one or more of the following US Patents: 5,937,969; 5,971,104; 5,975,242; 5,979,603; 6,125,966; 6,182,792; 6,397,973; D,417,011; D,420,147; D,575,411

Summit Bucksteps are Patent Pending

